

# SMS6000-P STUDIO MONITOR STANDS

**On-Stage®**  
STANDS

Congratulations on your purchase of the SMS6000-P Studio Monitor Stands Pair!  
Please read the following instructions carefully. *We hope you enjoy your new purchase.*

**Visit On-Stage for the most recently-updated instructions.**

Remove all contents from the box and identify the parts using these diagrams. \*Parts not drawn to scale.

## Components:



Square Monitor  
Platforms (x2)

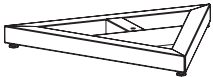

Triangular  
Bases (x2)



Adjustable Vertical  
Shafts (x2)



Long Hex Bolts  
with Washers (x2)



Leveling Carpet  
Spikes (x6)



Short Hex Bolts  
with Washers (x2)



Allen Wrench (2)

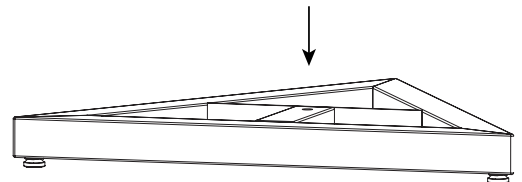
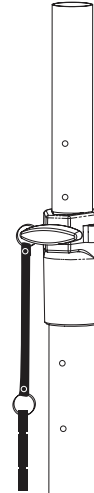
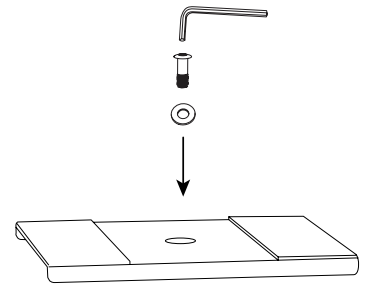

## Assembly Instructions:

1. Take one long hex bolt and one washer and insert through hole in center of one triangular base on side with rubber feet.
2. Thread the long hex bolt into the bottom of one vertical shaft and tighten hex bolt with the provided allen wrench to secure vertical shaft to triangular base.
3. Unthread and remove short hex bolt with washer located in the top of the vertical shaft.
4. Insert short hex bolt with washer through hole in the center of one monitor plate and thread into top of the vertical shaft. Secure monitor plate to vertical shaft with the allen wrench.
5. Adjust monitor plate height by loosening large thumb knob on clutch housing and move upper shaft to desired height.
6. Insert safety pin all the way through vertical shaft at lowest hole exposed, allowing the safety pin to rest on clutch housing. Secure by tightening large thumb knob on clutch housing.
7. When placing stand on carpet, remove the rubber feet from triangular base and screw in three leveling carpet spikes. Adjust carpet spikes so that the monitor platform is level.
8. Repeat steps 1 through 7 for second stand.



**CAUTION**

FAILURE TO OBSERVE PROPER ASSEMBLY INSTRUCTIONS, EXCEEDING THE WEIGHT CAPACITY OR FAILURE TO OBSERVE THE WARNINGS AS MENTIONED IN THIS INSERT MAY CAUSE BODILY INJURY OR EQUIPMENT DAMAGE AND WILL VOID THE PRODUCT WARRANTY.

**SMS6000-P**  
**STUDIO MONITOR STANDS**

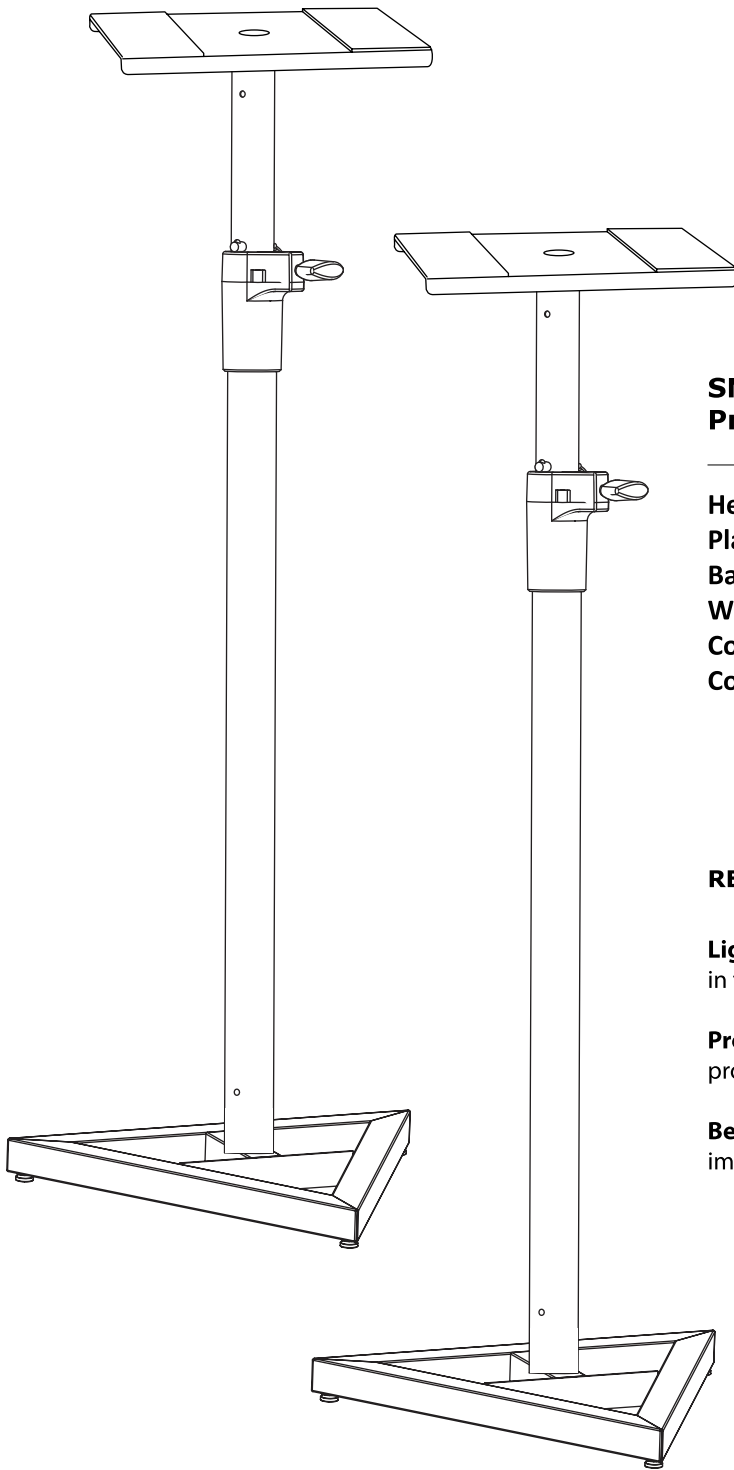

**SMS6000-P**  
**Product Specifications**

---

**Height Adjustment:** 36.5" - 54"

**Platform Dimensions:** 9½" Square platform

**Base Spread:** 18"

**Weight Capacity:** 90 lbs.

**Construction:** Steel

**Color:** Black Power Coat Finish

**REGISTER ONLINE. HERE'S WHY:**

**Lightning Fast Service** - Get the fastest turn-around in the unlikely event of a warranty claim.

**Product Notifications** - We can contact you directly with product notifications and safety information.

**Better Products** - Your registration helps us to improve our products and develop new ones.

**Questions or Concerns?** Contact the Customer Service Department at [cs@MusicPeopleinc.com](mailto:cs@MusicPeopleinc.com) or call us at (800) 289-8889.